

NOTE: EX50x25 BATTENS CAN BE SUBSTITUTED WITH EX50x50 WHERE APPROPRIATE

NOTE: SUBSTRATE TO BE FIXED IN STRICT ACCORDANCE WITH MANUFACTURER RECOMMENDATIONS AND LITERATURE

<b>ROOF ABUTMENT DETAILS LONGRUN ROOFING</b>	SCALE	DATE
	NTS	27/08/2019
	TILEMAX	MAXSTONE

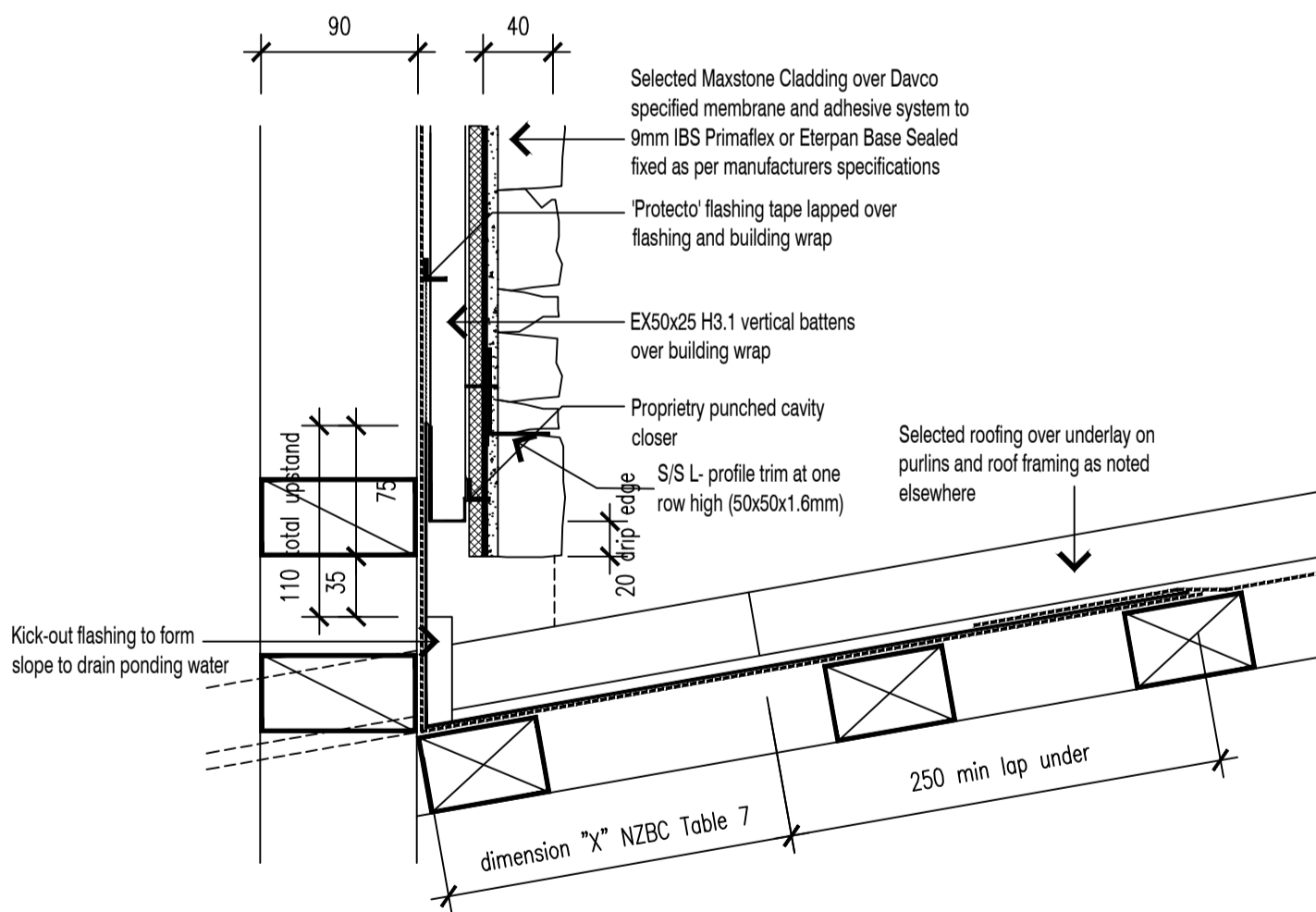

NOTE: EX50x25 BATTENS CAN BE SUBSTITUTED WITH EX50x50 WHERE APPROPRIATE

NOTE: SUBSTRATE TO BE FIXED IN STRICT ACCORDANCE WITH MANUFACTURER RECOMMENDATIONS AND LITERATURE

<b>ROOF ABUTMENT DETAIL LONGRUN ROOFING</b>	SCALE	DATE
	NTS	27/08/2019
	TILEMAX	MAXSTONE



TILEMAX LIMITED  
0508 TILEMAX

Maxstone suggested detail only - details to be approved by relevant city council and comply with NZBC where applicable.